

FILTER OVERVIEW WITH SERVICE INTERVALS AND CAPACITIES

W260 Windrower

CAB

FRESH AIR FILTER – [RE284091](#)

Replace as required or each season, whichever occurs first.

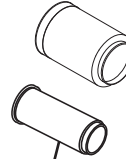
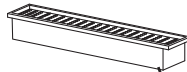
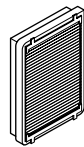

ENGINE

PRIMARY AIR FILTER – [AN403918](#)

Replace after 1 year service, or six cleanings, if air filter restriction warning light remains on as required or every season, whichever occurs first.

SECONDARY AIR FILTER – [AN403919](#)

Replace as required or each season, whichever occurs first.

ENGINE

OIL FILTER – [RE539279](#)

Replace after first 100 hours, then every 250 hours or each season, whichever occurs first. If Plus-50™ oil is used along with John Deere™ oil filter, the oil interval may be extended by 250 hours.

(Click here for [capacity](#))



CAB

RECIRCULATION AIR FILTER – [L155288](#)

Replace as required or each season, whichever occurs first.

HYDRAULIC

HYDROSTAT FILTER – [AH128449](#)

Replace every 400 hours or every season, whichever occurs first.

(Click here for [capacity](#))



HYDRAULIC

RESERVOIR VENT FILTER – [AT101565](#)

Replace every 400 hours or every season, whichever occurs first.

(Click here for [capacity](#))



ENGINE

DIESEL EXHAUST FLUID (DEF) DOSING UNIT FILTER – [RE554498](#)

Replace every 4500 hours or three years of operation, whichever occurs first.



ENGINE

CRANKCASE BREATHER FILTER – [RE553703](#)

Replace every 1500 hours.

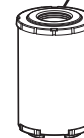

ENGINE

FUEL FILTER KIT (Includes Primary and Secondary) [RE556406](#) (Engine Option Code 35D5) PRIMARY FUEL FILTER [RE551507](#) (Engine Option Code 35JL, 35K3) SECONDARY FUEL FILTER [RE560681](#) (Engine Option Code 35JL, 35K3)

Replace every 500 hours or every season, whichever occurs first.



JOHN DEERE

Genuine Parts and Service

CAPACITIES

W260 Windrower

CAPACITIES (Approximate):

Fuel Tank:
Diesel Fuel

..... 586 L (155 gal)

Cooling System:
Cool-Gard™ II

..... 56.78 L (15 gal)

Engine Oil with Filter:
Plus-50™

..... 31.4 L (33.2 qt)

Hydraulic System (Reservoir):
Hy-Gard™

..... 95 L (25 gal)

Hydraulic System (Total):
Hy-Gard™

..... 143.8 L (38 gal)

Diesel Exhaust Fluid (DEF) Tank:

John Deere™ Diesel Exhaust Fluid

..... 24 L (6.34 gal)

Final Drives Each:
GL-5

..... 4.5 L (4.8 qt)

Pump Drive Gear Case:
Hy-Gard™

..... 3.8 L (4 qt)

Pump Drive Gear Case: (Including Cooling Loop)
Hy-Gard™

..... 5.7 L (6 qt)

[Return to Filter Overview](#)

